



September 20, 2015

See the Beauty of Southern Oregon
Along the Bear Creek Greenway
Enjoy the Bounty
At the Harvest Festival

Team Rogue welcomes you to the 2015 Providence Rogue Run.

We hope you enjoy the Rogue Valley's first Boston qualifying Marathon, Half Marathon and 10k. The route highlights cities in Southern Oregon including Ashland, Talent, Phoenix, Medford and Central Point. You will experience the Bear Creek Greenway and see the Valley from a beautiful perspective.

Detailed below is important information regarding the race, logistics and course courtesy that will help you enjoy the event and ensure enjoyment for other participants, spectators and community members.

The 2015 race has changed and added:

- Boston qualifying marathon starting at Emigrant Lake in Ashland and then connecting with the Bear Creek Greenway, and
- New age categories for awards which will receive gold, silver and bronze medals.

Some obstacles are present that are not within our control. The Fern Valley Interchange over Interstate 5 has redirected the Greenway up and over the road. This portion of the path is very narrow and has multiple, tight, 90 degree turns. Furthermore, it crosses over Fern Valley Road. There will be flaggers and Phoenix Police there to facilitate crossing traffic.

Our Team has been working hard to make this race a success and improve on the first four years. Your feedback was greatly appreciated and all comments evaluated and implemented to improve the race. After the race, you will be receiving a survey from us via email. Your insight and thoughts are appreciated in advance. Our goal is to not only have a wonderful running race in the Valley but have the event be well supported and one in which you will consider in the future. You can shape the Providence Rogue Run and your feedback will be considered carefully.

We are honored you participate in the Providence Rogue Run and look forward to a great race.

Thank you for embracing the Providence Rogue Run and enjoy!

Team Rogue

Michele Holcomb

Allen Purdy

Megan Purdy

Kelly Ravassipour

Darren Ravassipour

Laura Weiland

David Wright

THANK YOU PROVIDENCE ROGUE RUN SPONSORS

TITLE SPONSOR



MAJOR SPONSORS

sponsors

media sponsors

--	--	--	--

PAST WINNERS

PROVIDENCE ROGUE RUN

HALF MARATHON DISTANCE

	FEMALE OVERALL WINNERS	MALE OVERALL WINNERS
2011	Bree ray 1:22:15	LUKE VAUGHN 1:14:02
2012	reneE METIVIER BAILL 1:12:58	CRAIG LEON 1:07:08
2013	KIMBER MATTOX 1:19:38	CRAIG LEON 1:04:39
2014	MELISSA NEWBERY 1:17:47	CRAIG LEON 1:05:51

10K DISTANCE

	FEMALE OVERALL WINNERS	MALE OVERALL WINNERS
2014	BRIDGET FRANEK 37:29	JOSH GORDON 37:56

Important Race Information

Time Schedule

Packet Pick-up – Saturday, September 19, 2015

- 3-6pm at the Jackson County Expo Padgham Pavilion
 - 1 Peninger Road, Central Point, Oregon 97502
 - Enter through Gate 3 and park in the parking lot

Race Day – Sunday, September 20, 2015

- Bus Transportation to the Start
 - Buses transport participants from the Finish Line to the respective Starting Line for the 10k, half marathon and marathon.
 - Park at Jackson County Expo (same place as Packet Pick-up) but enter through Gate 4. The buses will be in the parking lot waiting for you.
 - Marathon participants
 - 5:30-6:15am – Loading times. The last bus will leave promptly.
 - Half marathon and 10k participants
 - 6:30-7:15 am – Loading times. The last bus will leave promptly.
- Marathon Starting Line and Staging
 - 5:30 am – Staging for the Start open
 - 6:45 am – Pre-race instructions for all Participants
 - 7:00 am – Wheelchair Division Start
 - 7:10 am – Race starts by expected pace (fastest pace first)
 - PLEASE START IN YOUR EXPECTED PACE AREA
 - WALKERS WILL BE IN THE BACK OF THE QUEUE
 - FAST RUNNERS, PLEASE MOVE TO THE FRONT
- Half marathon and 10k Starting Line and Staging
 - 6:30 am – Staging for the Start open
 - 7:45 am – Pre-race instructions for all Participants
 - 8:00 am – Wheelchair Division Start
 - 8:10 am – Race starts by expected pace (fastest pace first)
 - PLEASE START IN YOUR EXPECTED PACE AREA
 - WALKERS WILL BE IN THE BACK OF THE QUEUE
 - FAST RUNNERS, PLEASE MOVE TO THE FRONT
- Finish Line and Staging
 - 9:15 am – Beer garden opens
 - 9:15 am – Bag Pick-up for participants open
 - 9:15 am – Expected first runner finishing.
 - 12:15 am – Awards Ceremony
 - Must be present to win and receive awards
 - 1:00 pm – Race Closes
 - 1:30 pm – Bag Pick-up closes
 - 1:30 pm – Beer garden closes

Packet Pick-Up

Saturday, 9/19 from 3-6pm at the Jackson Co. Expo

- Location – Padgham Pavilion at Jackson County Expo
 - 1 Peninger Road, Central Point, Oregon 97502
- Parking – Enter at Gate 3 and park in the paved lot.
 - If coming from Interstate 5, take the Exit 33 on East Pine Street.
 - Go East and then turn North on Peninger Road until Gate 3
- Bring identification with you to receive your race packet.
 - **You can get race packets for others but they need to either give some form of identification or a photocopy of their identification to receive another's packet.**
 - **No identification, no packet.**
 - Please do not give the volunteers a hard time for checking your identification, it is to protect your participation in the event.
- You will receive the following:
 - Bib and disposable timing chip
 - Providence Rogue Run Kleen Kanteen
 - Dry fit technical T-shirt
 - Goodie bag
 - White trash bag with your bib number if you wish to use the bag drop/pick-up which will transport items from the starting line to the finish line.

Bus Transportation

- Bus transportation is for participants from the Finish Line to the Start
 - There is minimal parking at the start for each race distance.
 - Anyone going to the marathon start that isn't on the bus will be charged the Jackson County parking fee even for dropping off participants.
- Please park in the same location as Packet Pick-up but enter Gate 4 (just beyond Gate 3).
 - 1 Peninger Road, Central Point, Oregon 97502
- Buses leave from parking lot in Expo area promptly at Gate 3.
- Board buses between on race day at:
 - 5:30-6:15am for marathon participants, and
 - 6:30-7:15am for half marathon and 10k participants.

Starting Line and Staging

- See map for visual information and details.
- Marathon Location – Emigrant Lake Park in Ashland
- Half Marathon Location – 160 N. Pacific Highway, Talent, Oregon 97540
 - Clearview Road between Highway 99 and Suncrest in Talent
 - Clearview Center businesses are on Highway 99 (Subway, Talent Café)
- 10k location – Bear Creek Park (off Highland near the corner with Barnett Road)
- Facilities
 - Water will be available in limited quantity

- Porta-potties are in the staging area
- Information tables will be at the Starting Lines
- Bag Drop
 - If desired, place your items which you will need in the staging area but not on the run in the white trash bag provided labeled with your bib number.
 - Drop off prior to starting in the bag drop located near the information table.
 - Items will be transported to the finish line and pick up will be in the participants' only area.
 - While we will make every effort to secure your belongings, use at your own risk.
- General instructions
 - Chip Timing. Disposable chips will be on the back sides of your bib.
 - Wear your bib in the front.
 - No animals, rollerblades, inline skates or strollers permitted.
 - Keep to the right at all times unless passing.
 - Follow all State road laws when on public streets
 - Walk/run in no more than two abreast.
 - The Bear Creek Greenway is a public park – it is open to the public. Share the path with other pedestrians and cyclists. Take caution on the course for others.
 - Pick up your trash. Multiple trash cans are located on the course for your convenience.
 - Follow flagger and aid station volunteer instructions when racing.
- Participants
 - PLEASE GO TO YOUR APPROPRIATE PACE AT THE START
 - Walker – Stay right at all times and no more than two abreast.
 - Runners – Announce when passing and be courteous.
 - For the marathon, stay to the right of the Fog Line when on the roads.
 - All directional markings on the course will be in white chalk
 - Mile markers for the marathon will be in white chalk, the half marathon mile markers will be blue chalk and the 10k in orange chalk.

The Rogue Run Course Logistics

- See map for visual details and information.
- Flaggers are located often along the course to facilitate following the path.
 - Flaggers will be directing participants on the road segments of the race and not the motorized vehicles. Follow Oregon law when on roads.
- Aid Stations
 - 11 aid stations will be on the course.
 - While detailed below, all aid stations will have water, Safeway Refreshes Electrolyte Drink and some aid stations will have food items.
 - Water will be handed out prior to Refreshes Electrolyte Drink followed by food items if given. This order will be followed at each station.
- Table of Temptation – Two miles from the finish
 - Test your determination and stop for a treat.
 - Wine and beer shots for participants over 21.
 - Enjoy the treats!

- Porta-potties are available at:
 - Starting Line staging area
 - Waste Water Treatment Plant Road Aid Station
 - Lyn Newbry Park Aid Station
 - Blue Heron Park Aid Station
 - US Cellular Park Aid Station
 - Hawthorne Park Aid Station
 - Crater Lake Aid Station – last restroom location until the finish
 - Finish line restrooms open to participants only.
 - Change clothing in the stalls as desired.
- First Aid/Medial Tent
 - Medical Tents will be located at:
 - Wastewater Treatment Plant Road Aid Station,
 - Lyn Newbry Park Aid Station,
 - Hawthorne Park Aid Station, and
 - Finish Line.
 - Mercy Flights Explorers, a group of medical providers and support from Providence Medford Medical Center will be available for light first aid.
 - If there is an emergency, call 911 immediately.
- Public Road Crossing
 - Officers and flaggers will be on the course – follow their directions
 - Marathon participants – The first eight miles of the race will be on public roads. Please stay to the right of the fog line and follow the cones/flaggers. Watch out for vehicle traffic as it is a public, open street.
 - Suncrest – The half marathon race will start on Clearview in Talent and take an immediate right on Suncrest. You will travel about a quarter of a mile east on Suncrest until you take a left (north) onto the Bear Creek Greenway.
 - Follow flaggers and cones.
 - Talent and Medford Police will be on-site.
 - Watch out for vehicle traffic as it is a public, open street.
 - US Cellular Park access road crossing – The run will cross over the access road when you enter the park. Crossing of the bridge will be on the north side of the street on the side walk where there is a bike lane. Vehicles travel fast so be defensive.
 - Follow the four flaggers directions.
 - Stop if necessary.

Finish Line and Staging

- See map for visual details and information
- Harvest Festival at the Expo – Admission is free for both Participants and Spectators.
- Parking – participants and spectators can park and walk to the finish inside the Harvest Festival (see Entrance into Harvest Festival above).
 - Parking is in the same location as for Packet Pick Up through Gate 4.
- Grandstands are available at the finish where you can watch participants enter and cross the finish line.
- Bananas and Safeway Eating Right Bars and water will be available at the finish.

- Finisher Medals and Bag Pick-Up
 - Participants only area detailed on the map has restrooms for your use.
 - Please do not give the volunteers a hard time for checking your identification, it is to protect your personal items.
 - **Bag pick-up will be located in this area. No bib, no bag.**
 - Finishers medals will be given out at the finish.
- Penrose Photography will be taking pictures along the race. Please have your bib in the center of your chest for identification along the course and the finish line.
- Beer Garden –beer will be available for purchase.
 - **Each participant over 21 will receive one beer for FREE. No bib, no free beer.**
 - It is open from 9:15 am until 1:30 pm.
- Additional Family Activities – Jackson County Harvest Festival has many family oriented activities with several types of vendors available. Please see the website for details. www.jcfairgrounds.com.

Results – every 15-30 minutes at the finish, results will be posted on the side of the Mace Building inside the Harvest Festival. Results will be available on-line at www.theroguerun.com.

Awards and Ceremony

- Awards ceremony for the following categories will be given out at 12:15 pm.
 - Marathon overall male and female winners -- \$1,000, \$500 and \$250
 - Half marathon overall male and female winners -- \$500, \$250 and \$120
 - 10k overall male and female winners --
 - Top three male and female runners in the following age group categories will receive medals for each of the three distances:
 - Under 20
 - 20-24
 - 25-29
 - 30-34
 - 35-39
 - 40-44
 - 45-49
 - 50-54
 - 55-59
 - 60-64
 - 65-69
 - 70 and above
 - You must be present to win and receive awards.

Lost and Found – please email theroguerun@gmail.com if you lose track of anything. We will keep unclaimed materials as long as possible.

Emergency Race Contacts:

Darren Ravassipour (541) 944-5097 race director

David Wright	(541) 301-7125	race director
Laura Weiland	(541) 968-6340	race administrator

Providence Rogue Run Packet Pick-Up Saturday, September 19th from 3-6pm

Harvest Festival @ Jackson County Fairgrounds
1 Peninger Road, Central Point, Oregon 97502

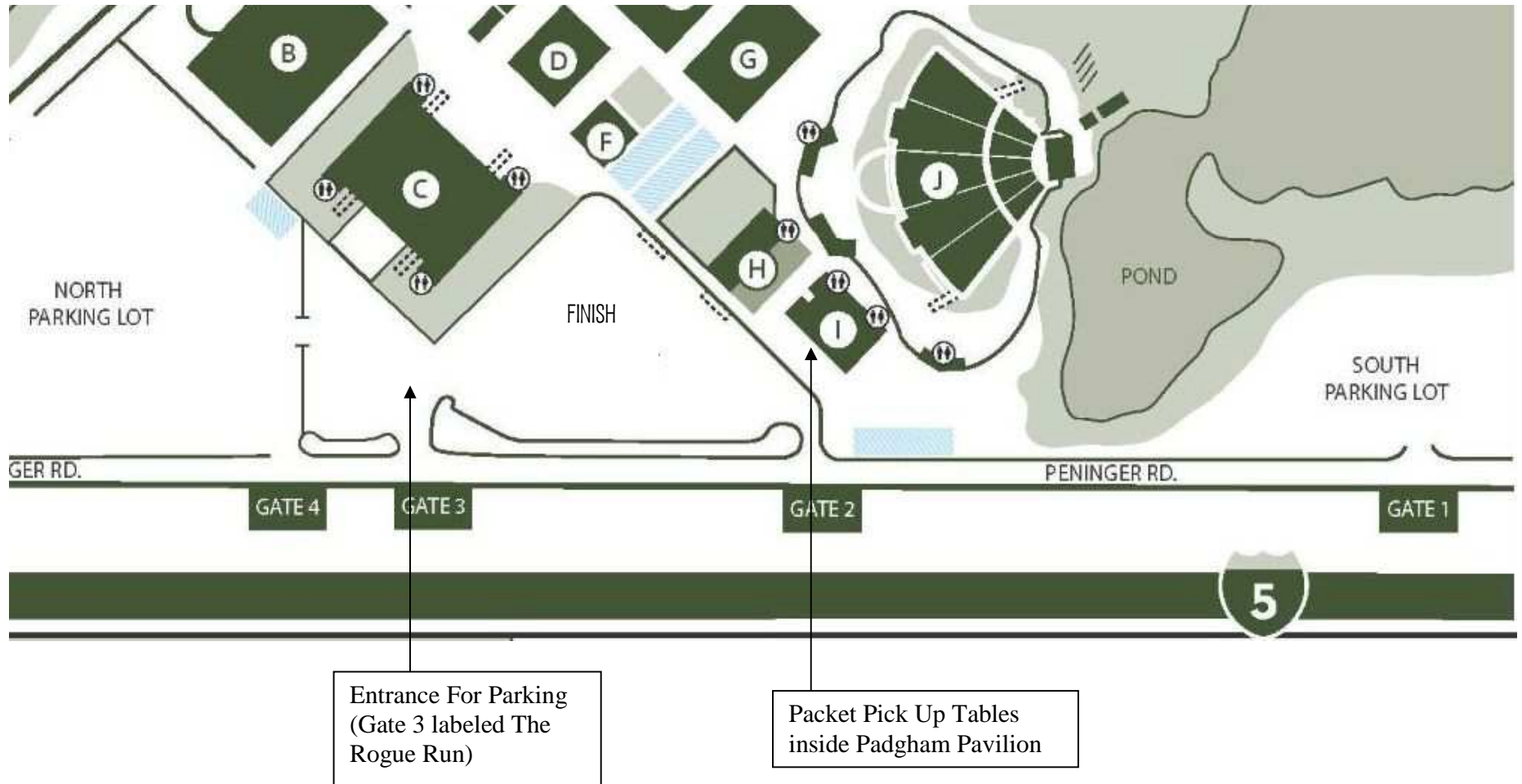

MARATHON START – SUNDAY START AT 7:10AM



HALF MARATHON START – SUNDAY AT 8:10AM

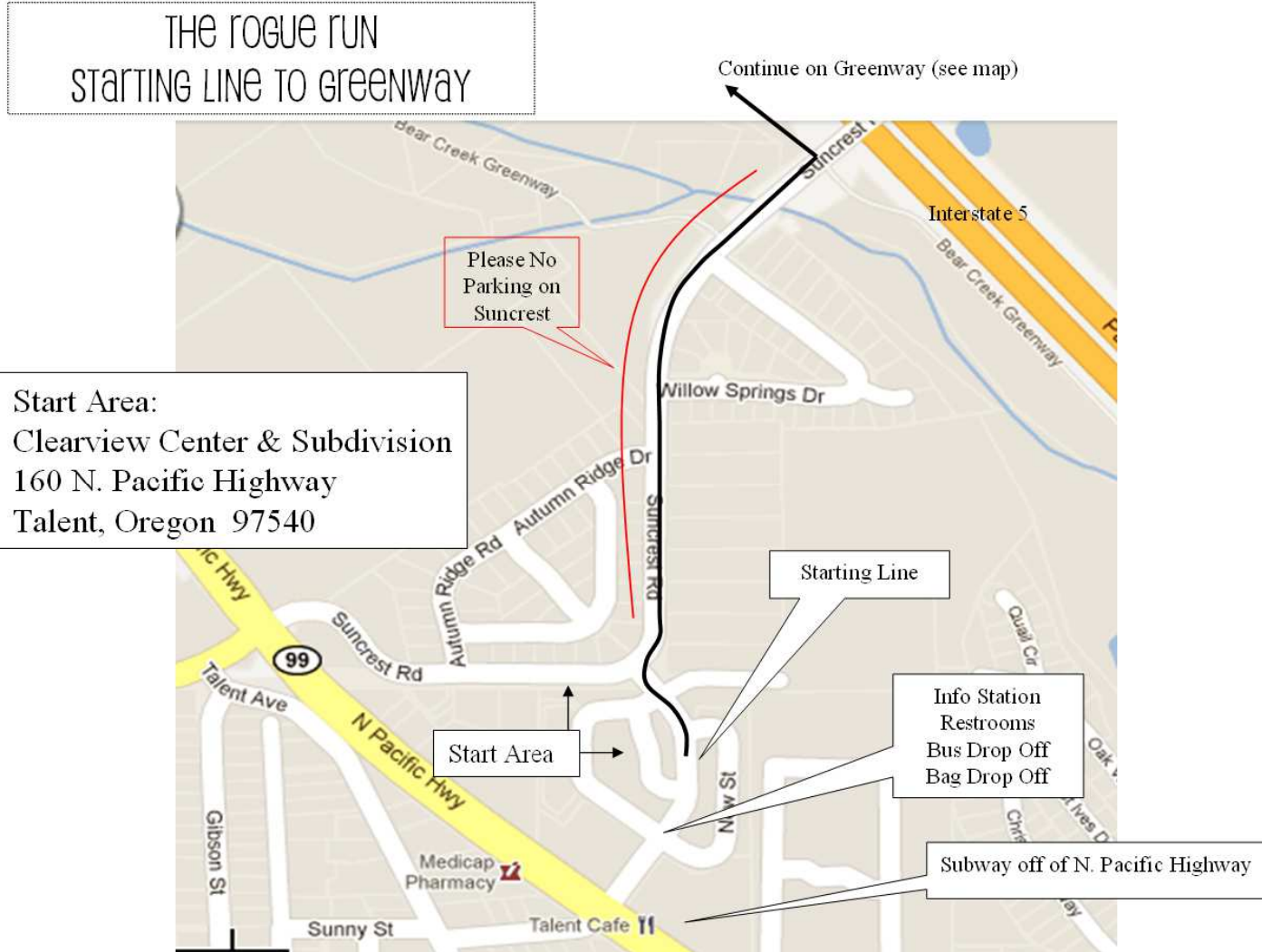

10K START – SUNDAY at 8:10am

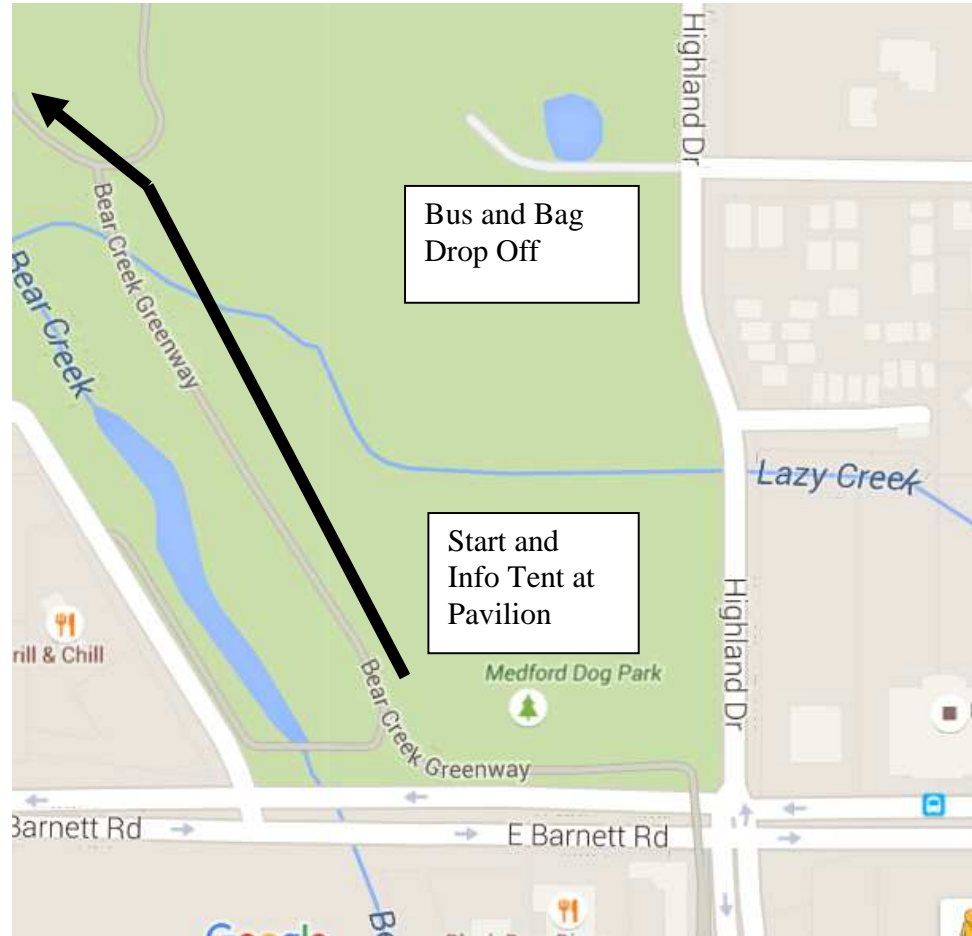

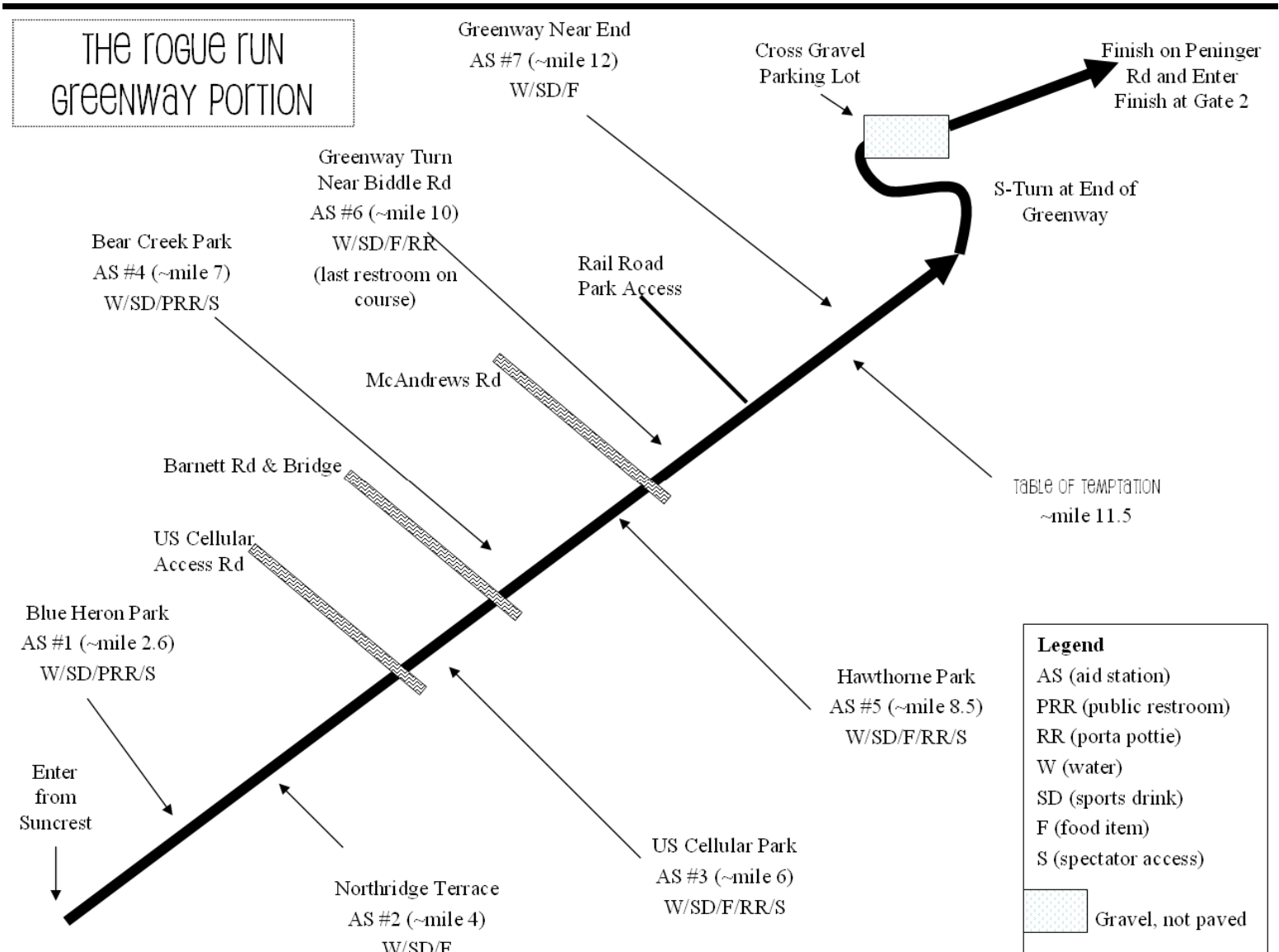

Providence Rogue Run

Finish Line and Staging, Sunday September 20

Harvest Festival @ Jackson County Fairgrounds
 1 Peninger road, Central Point, Oregon 97502

Beer Garden
 Results Posting
 Finisher Medal
 Pick-Up

Participant Bag
 Pick Up and
 Restrooms

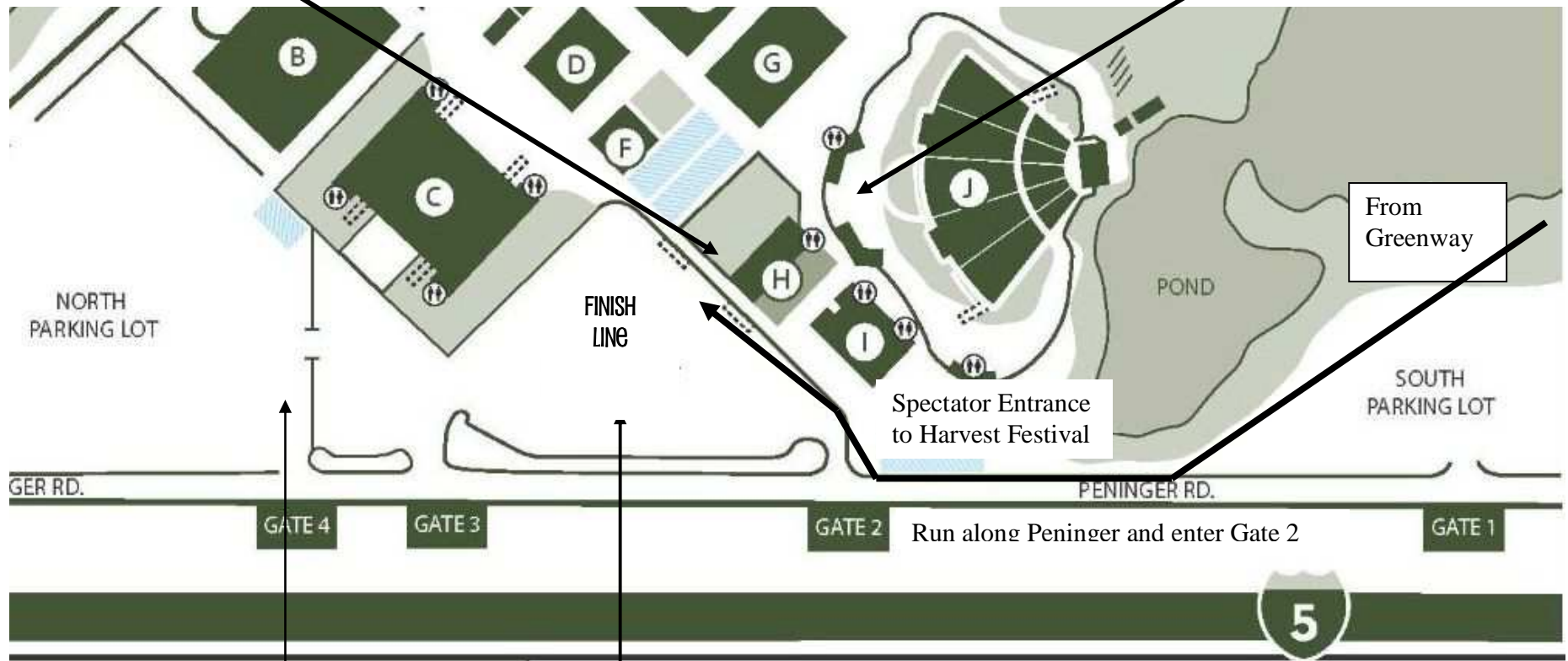

Entrance For Parking
 (Gate 4 labeled The
 Rogue Run)

Finish Line and Grandstands